



**RJ-107101-101 JL, JT & JK ADJUSTABLE FRONT UPPER BUMP STOP KIT  
INSTALLATION INSTRUCTIONS & TECHNICAL MANUAL**



Thank you for purchasing our JL, JT & JK adjustable front bump stop kit! SEMA's 2023 Best New Off-Road Product of the Year! In high articulation situations, an axle housing mounted bump stop ends up rotating inward toward the center of the vehicle, often missing the upper bump stop entirely. By lowering the upper bump stop, and being able to adjust it's length, you are able to guarantee bump stop contact when and where you need it. Our adjustable kit features billet aluminum components and 5/16 in. thick steel shims that are able to be added and subtracted for fine tuning while the bump stop assemblies are on the vehicle. You simply put a socket on the upper bolt to hold it in place and loosen the bump stop body with the supplied spanner wrench, add or subtract bump stop shims and then tighten the assembly back up!

**Kit Includes**

- 2) RJ-107101-1.....Billet Aluminum Bump Stop Upper Half
- 2) RJ-107101-3.....Billet Aluminum Bump Stop Lower Half
- 8) RJ-107101-5.....5/16" Thick Steel Shim
- 2) RJ-501107-1.....12mm-1.75 x 50mm Long Flanged Hex Bolt
- 1) RJ-560000-1.....Spanner Wrench



**SEMA SHOW'S 2023  
BEST NEW OFF-ROAD/4WD  
PRODUCT OF THE YEAR**

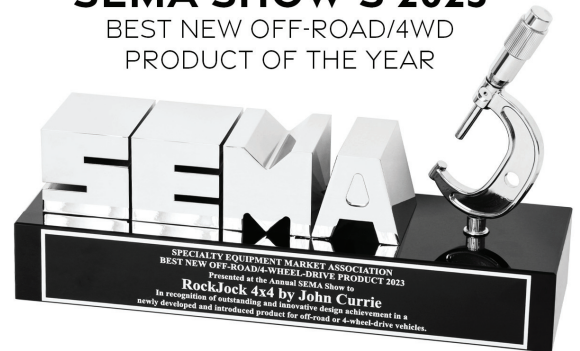

**WWW.ROCKJOCK4X4.COM**

@ROCKJOCK4X4 /ROCKJOCK4X4 /ROCKJOCK4X4BYJOHNCURRIE

## Step 1

Start by safely supporting your vehicle and removing your front coil springs, as well as any extended bump stop equipment that your vehicle is currently equipped with at the frame, and/or the axle.

## Step 2

Remove the stock jounce bumpers from your chassis and retain them for reuse.  
If it so happens that these pieces have already been removed from your vehicle - new ones can be obtained from Mopar / the Jeep dealership under Mopar part number: 68480876AA

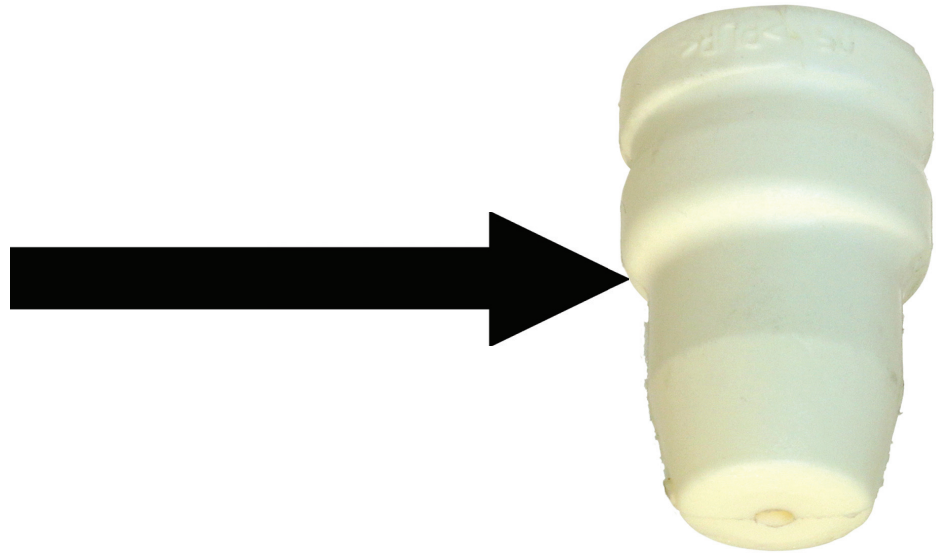

## Step 3

The billet aluminum upper bump stop halves fit into the bore in the frame that you removed the jounce bumpers from.

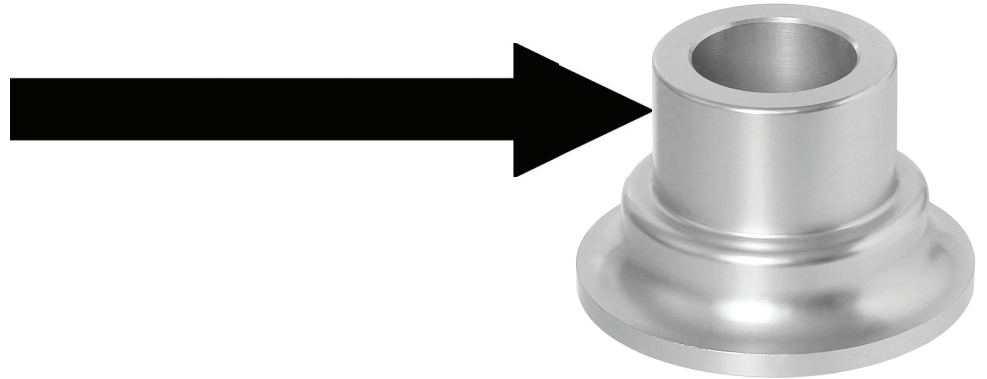

## Step 4

You'll find a total of eight 5/16" bump stop shims in the kit - 4 for each side.

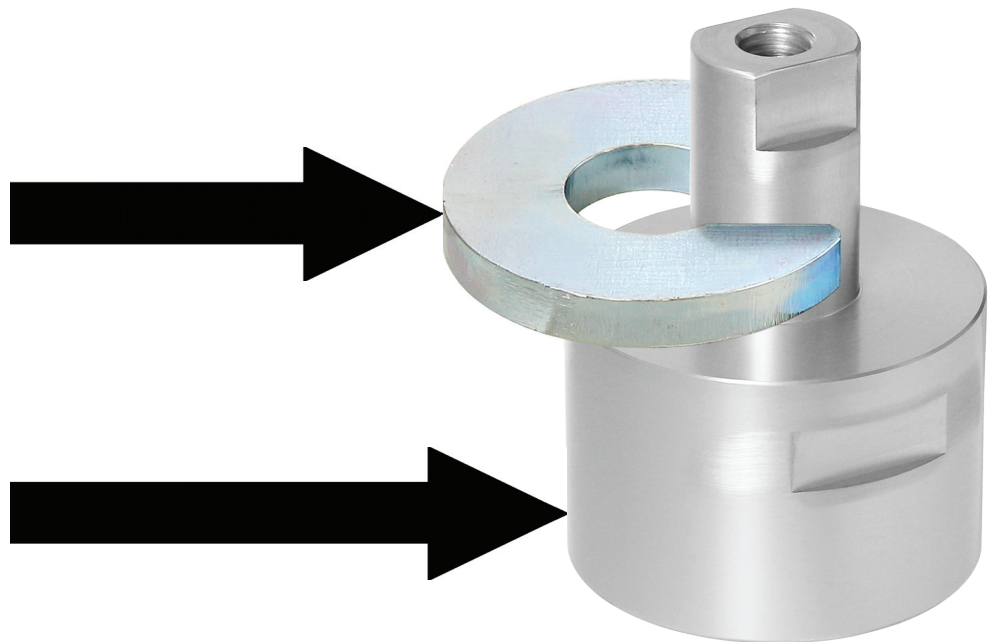

## Step 5

The billet aluminum lower bump stop halves feature the mast that the shims hub onto, threaded hole in the top for the attaching bolts, machined flats for the spanner wrench and a bore in the bottom where the stock jounce bumpers are reinstalled.

## Step 6

Two 12mm-1.75 x 50mm long flanged hex head bolts are included in the kit. These bolts drop in from the top side of the upper bump stop frame tube (as shown on page 4) and then thread into the threaded hole in the top of the billet aluminum lower bump stop halves.

Installation of this bolt and, for future adjustments of the bump stop, you'll need a 16mm socket and a 6" long extension to reach down the frame to get to it.

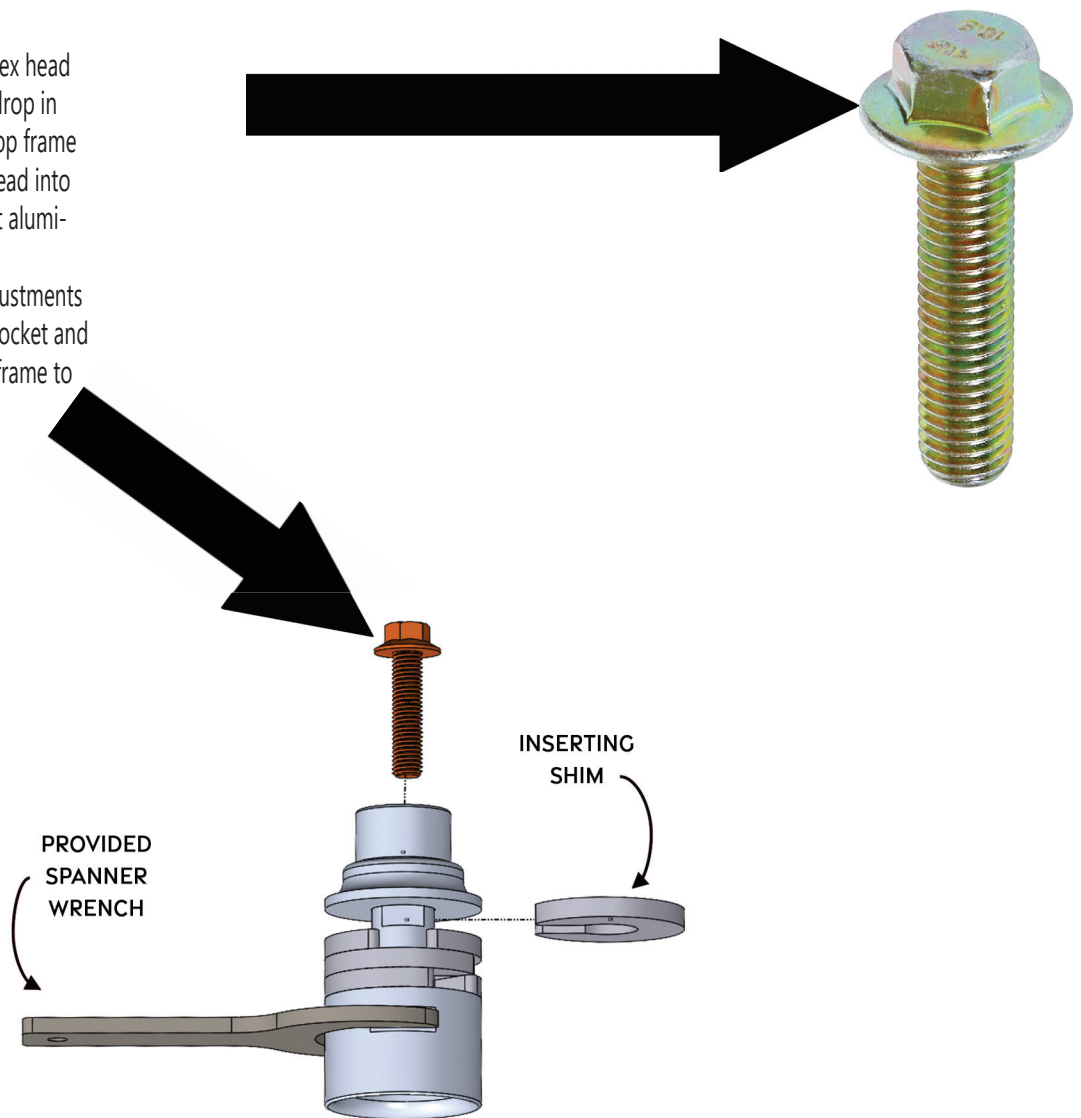

## Step 7

We include a spanner wrench in this kit for ease of use of the adjustability feature.



## Step 8

Essentially, once the kit is installed on the vehicle, you may reinstall your coil springs as normal and set the vehicle back on the ground.

Then, you may articulate your vehicle, via whatever means available and determine how high your axle can safely go upon up travel.

This kit allows you to maximize travel by fine tuning your uptravel (bump) stop - 5/16" at a time.

Simply drop a 16mm socket connected to a 6" extension into the bump stop tubes from the top, slide this spanner wrench in thru the sides of the coil springs and lock it onto the lower bump stop halves, loosen the bolts (provided in the kit) and allow the lower bump stop halves to lower down, allowing you to add or remove shims. When you are satisfied with your adjusted shim pack, just hold the spanner wrench and tighten the bolt and torque to 48 ft. lbs.!

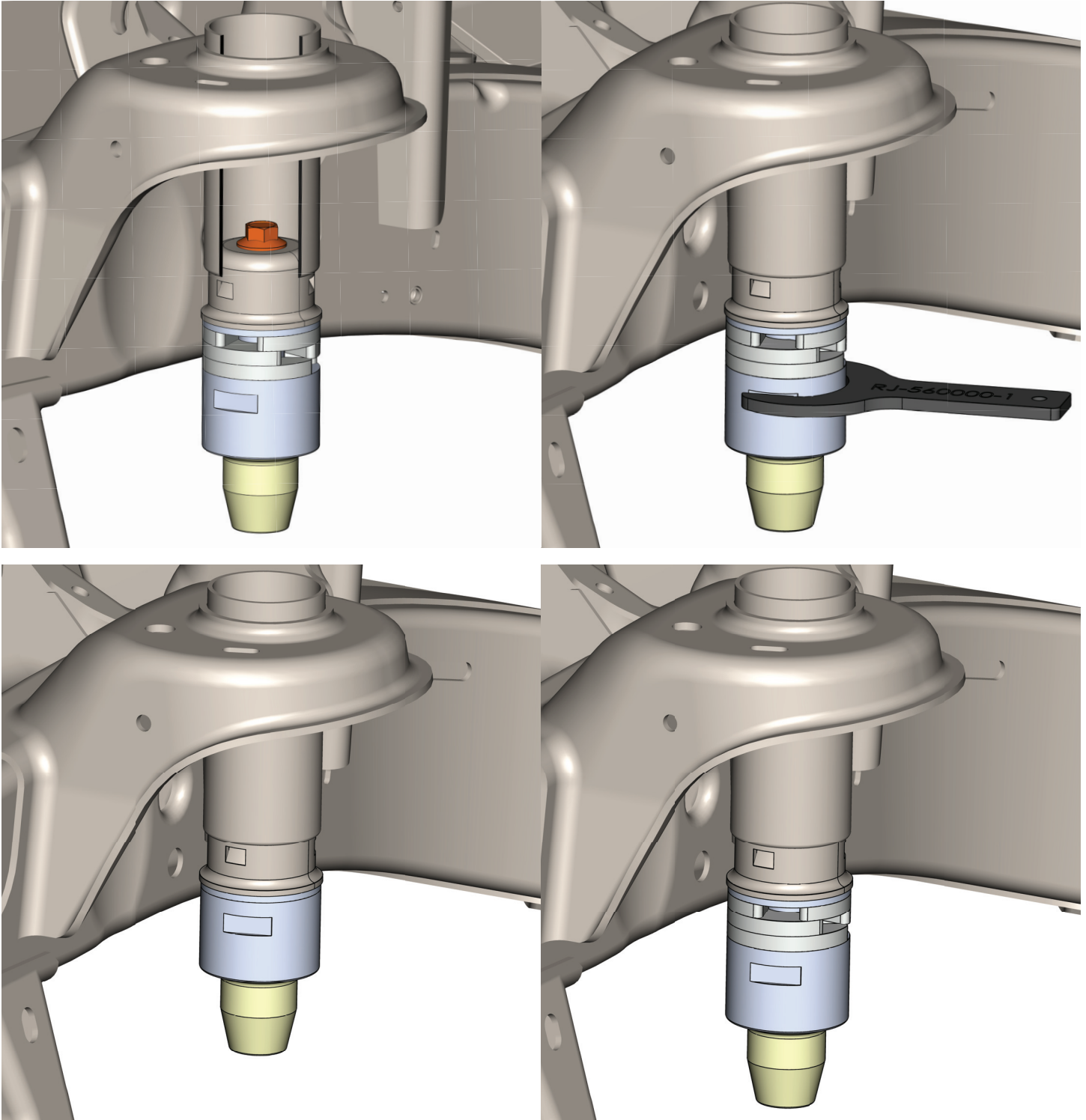

## Step 9

Below you will see your available adjustment range with the Adjustable Upper Bump Stop Kit installed.

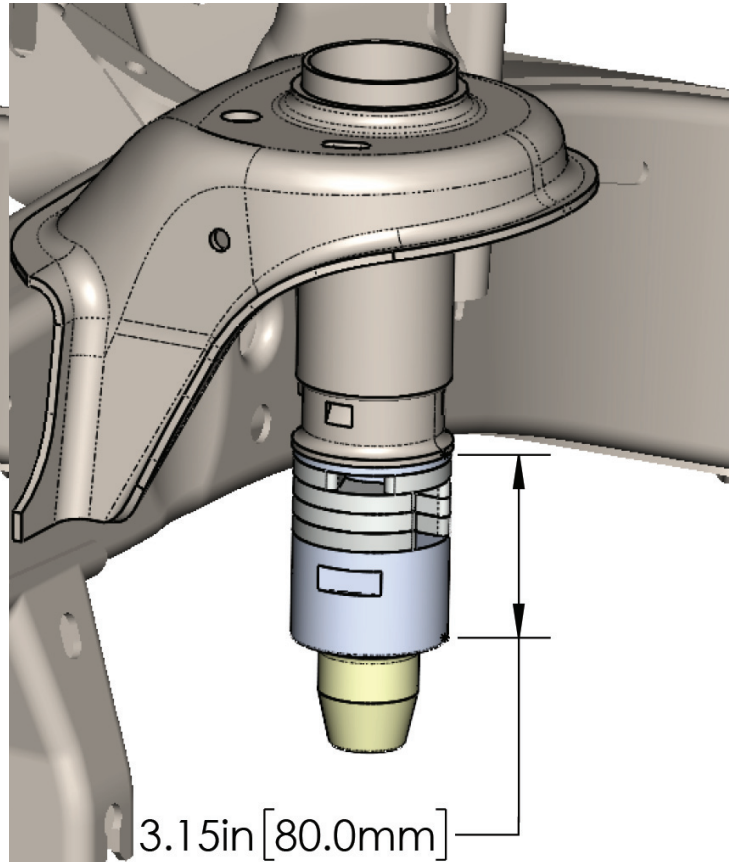
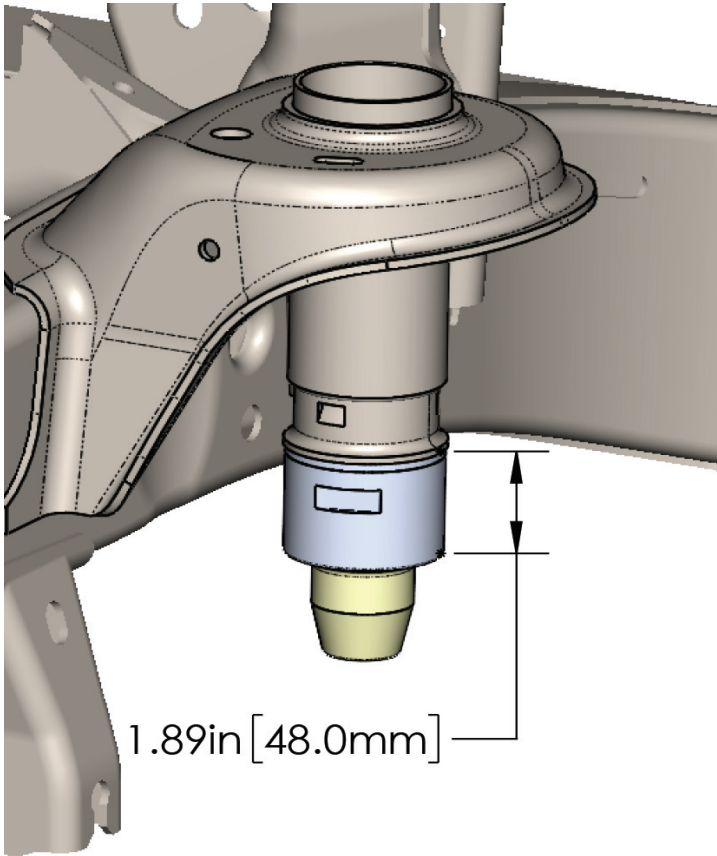

## Step 10

As you can see by the diagrams below, as front axles articulate, axle mounted bump stops rotate inward, often missing the upper bump stop entirely. With a fixed, adjustable upper bump stop, you are guaranteed efficient bump stop function.

